

The Transport and Works Act 1992 The Felixstowe Branch Line and Ipswich Yard Improvement Order

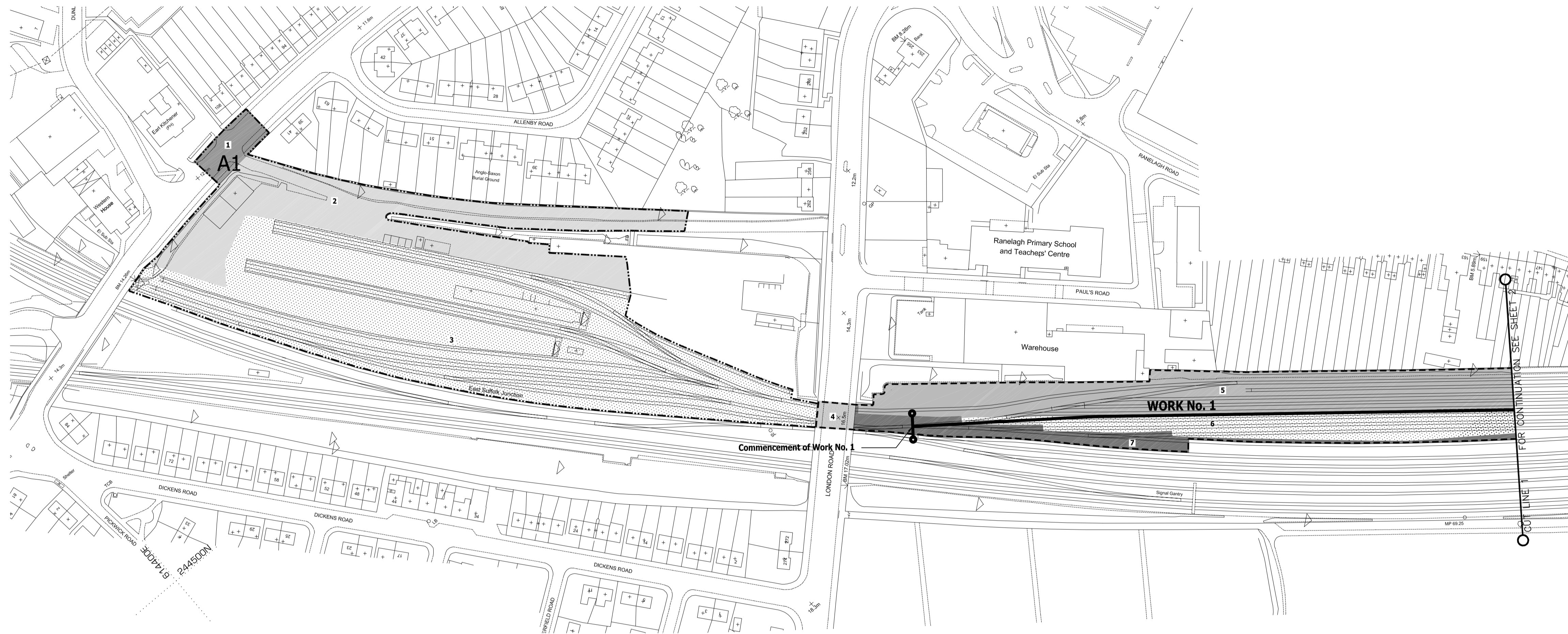
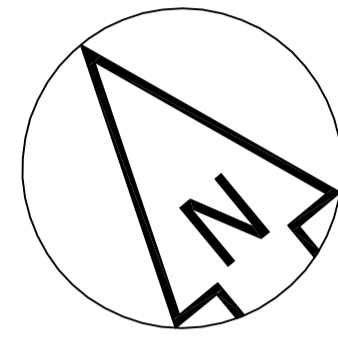

KEY

- Centreline of Scheduled Work
- Limits of Deviation
- Limits of Land to be Acquired or Used
- Limit of Scheduled Work
- Access to be provided or improved

Based upon the Ordnance Survey mapping with the permission of the Controller of Her Majesty's Stationery Office © Crown copyright. Unauthorised reproduction infringes Crown copyright and may lead to prosecution or civil proceedings. Licence No. 100000000

PLAN

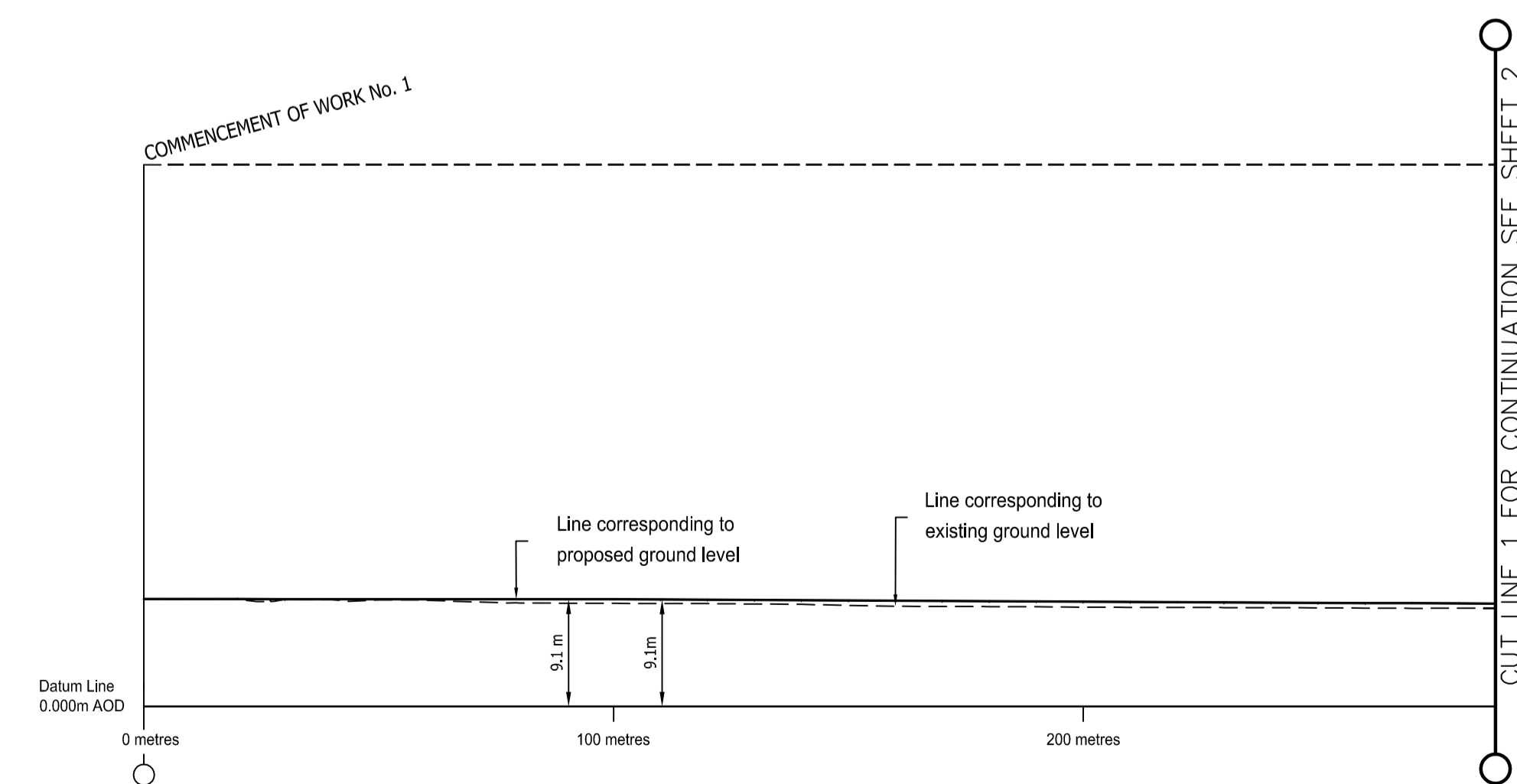

WORK No. 1 - Part 1

SECTIONS

